

# MPT Series Pressure Transducers

Up to  
1000 bar, 10000 psi

The MPT pressure sensors are designed for continuous monitoring of oil, gas, water, hydraulic and other pressure media in mobile equipment, industrial hydraulics, compressors and process control equipment.

Economical price and rugged design allows the MPT transducers to be designed into O.E.M. machinery to give control and condition monitoring information. The compact construction makes it ideal for installing where space is at a premium.

Combined with one of the wide range of Webtec digital readouts both continuous and peak pressures can be measured.

The MPT series utilises thin film techniques along with fully automated production methods to produce a standard of performance previously only associated with high price pressure transducers.



Manufacturers of hydraulic components and test equipment  
for the Mobile, Industrial and Agricultural industries



Nuffield Road,  
St. Ives, Cambs.,  
PE27 3LZ, UK  
Tel: +44(0)1480 397400  
Fax: +44(0)1480 466555  
www.webtec.co.uk  
E-mail: sales@webtec.co.uk

## Features:

- **ACCURATE**  
( $\pm 0.25\%$  Full Scale)
- **ECONOMICALLY**  
priced
- **RUGGED** design
- **OUTPUT OPTIONS:**  
4 - 20mA or 0 - 5V
- **STAINLESS**  
Steel wetted parts
- **CONNECTOR:**  
Male 4 pin M12 x1.0
- **TWO** thread forms  
available



## Specification

Model number	Outputs available	Pressure range (Gauge)	Pressure Connection
MPT016BB**	5V, mA	16 bar	1/4" BSPP
MPT040BB**	5V, mA	40 bar	1/4" BSPP
MPT100BB**	5V, mA	100 bar	1/4" BSPP
MPT250BB**	5V, mA	250 bar	1/4" BSPP
MPT400BB**	5V, mA	400 bar	1/4" BSPP
MPT600BB**	5V, mA	600 bar	1/4" BSPP
MPT1000BM**	5V, mA	1000 bar	M12 x 1.5
MPT200PU**	5V, mA	200 psi	7/16" -20UN #4 SAE ORB Male
MPT600PU**	5V, mA	600 psi	7/16" -20UN #4 SAE ORB Male
MPT1K5PU**	5V, mA	1500 psi	7/16" -20UN #4 SAE ORB Male
MPT4K0PU**	5V, mA	4000 psi	7/16" -20UN #4 SAE ORB Male
MPT6K0PU**	5V, mA	6000 psi	7/16" -20UN #4 SAE ORB Male
MPT7K5PU**	5V, mA	7500 psi	7/16" -20UN #4 SAE ORB Male
MPT10K0PU**	5V, mA	10000 psi	7/16" -20UN #4 SAE ORB Male

Replace \*\* with mA or 5V to give complete model number

### Functional specification

**Operating temperature:** Ambient - 5 to 40°C (41 to 104°F)  
**Fluid temperature:** -20 to 100°C (-4 to 212°F) Compensated range  
**Temperature effects:** ±2% Full scale typical  
**Accuracy:** ± 0.25% Full scale  
**Proof pressure:** Minimum 2 times full scale  
**Weight:** 53g (0.1 lbs)

### Electrical specification

**Supply voltage (VS):** 10 - 30 VDC all models  
**Current output:** 4- 20 mA, 2 wire loop, max loop resistance = (VS-7.5) x 50 ohms  
**Voltage output:** 0 - 5 VDC, current consumption = 8mA  
**Connection type:** M12 x 1 4 pin

### Construction material

**Body:** 17-4PH stainless steel (wetted parts)

### Connection Details

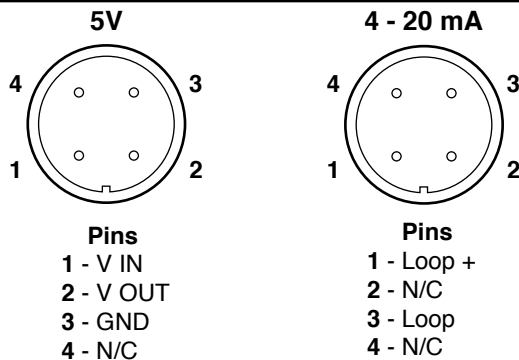

<b>Connecting cable</b> (5m)	FT9879-05
<b>Extension cable</b> (5m)	FT10229-5
<b>Connector</b> (M12x1 4 pin)	FT9880

### Dimensions (mm)

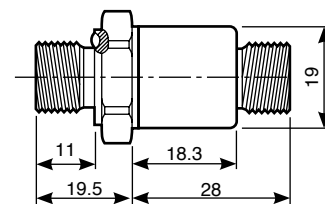

N.B. 11 and 19.5 dimensions are 16.5 and 23 for MPT1000BM\*\* transducers

### Accessories

For Panel meters (readouts) see DP 130 bulletin  
 For temperature transducers TP bulletin  
 For flow meters see CT, CTR or flowhub bulletin

For help and advice, please contact Webtec sales office.



**APPROVED**